

OIL DIAPHRAGM SEAL (4WD)

REPLACEMENT

HINT:

COMPONENTS: See page 29-3.

1. **REMOVE EXHAUST PIPE ASSY CENTER** (See page 15-4)
2. **REMOVE PROPELLER W/CENTER BEARING SHAFT ASSY** (See page 30-6)
SST 09325-20010
3. **REMOVE REAR DIFFERENTIAL FILLER PLUG**
 - (a) Using a hexagon wrench (10 mm), remove the filler plug and gasket.
4. **REMOVE REAR DIFFERENTIAL DRAIN PLUG**
 - (a) Using a hexagon wrench (10 mm), remove the drain plug and gasket, drain the oil.
Torque: 39 N·m (398 kgf·cm, 29 ft·lbf)
5. **REMOVE REAR DIFFERENTIAL CARRIER COVER**
 - (a) Remove the 4 bolts and differential carrier cover.
 - (b) Using a brass bar and a hammer, tap the rear differential carrier cover to remove the rear differential carrier cover w/ transmission coupling assy from the rear differential carrier assy.

NOTICE:

- Place the brass bar on the rib of the rear differential carrier cover.
 - Do not drop the rear differential carrier cover w/ transmission coupling assy.
6. **REMOVE TRANSMISSION COUPLING CONICAL SPRING WASHER**

HINT:

Check the direction of the washer to face.

7. **REMOVE TRANSMISSION COUPLING SPACER**

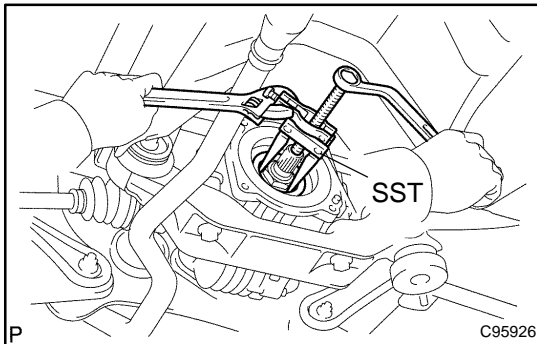

8. **REMOVE OIL DIAPHRAGM SEAL**
 - (a) Using SST, remove the oil diaphragm seal.
SST 09308-10010

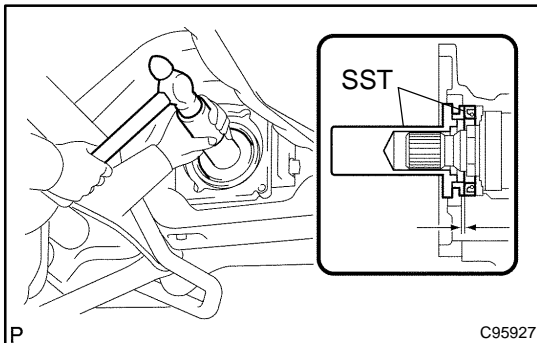

9. **INSTALL OIL DIAPHRAGM SEAL**
 - (a) Using SST and a hammer, install a new oil diaphragm seal.
SST 09506-35010, 09554-22010
Oil seal drive in depth:
0.7 – 1.3 mm (0.03 – 0.05 in.)
 - (b) Apply MP grease to the oil seal lip.

10. **INSTALL TRANSMISSION COUPLING SPACER**
11. **INSTALL TRANSMISSION COUPLING CONICAL SPRING WASHER**

NOTICE:

Install the washer so that the making position faces to the front side of the vehicle.

12. INSTALL REAR DIFFERENTIAL CARRIER COVER

- (a) Install the differential carrier cover with 4 bolts.

Torque: 20 N·m (204 kgf·cm, 15 ft·lbf)

13. INSPECT AND ADJUST DIFFERENTIAL OIL (See page 29-7)**14. INSTALL REAR DIFFERENTIAL FILLER PLUG (See page 29-7)****15. INSTALL PROPELLER W/CENTER BEARING SHAFT ASSY (See page 30-6)****16. INSTALL EXHAUST PIPE ASSY CENTER (See page 15-4)****17. CHECK EXHAUST GAS LEAK (See page 15-4)**